

# Quick Start Guide

## Samsung Bluetooth® Headset WEP180

Get connected in 4 quick steps

- Charge your headset
- Put your headset in pairing mode
- Turn on Bluetooth on your phone and pair with headset
- Test and use

Start here →

■ **Headquarters:**  
1301 East Lookout Drive Suite 150  
Richardson, TX 75082

■ **Internet Address:**  
<http://www.samsungmobileusa.com/accessories>

■ **Customer Care Center:**  
1-888-987-4357



## Before using your headset

Thank you for purchasing the Samsung Bluetooth Mono Headset WEP180, we hope you will be delighted with its operation. Take a moment before you get started to familiarize yourself with your new headset.



## Check the accessories

Make sure you have the following items with your headset:

Travel adapter, User's Guide, 1 ear hook

- NOTE:**  
The items supplied with your headset and the accessories at your Samsung dealer may vary, depending on you country or service provider.

- *Bluetooth version: 2.0 (compatible with devices of Bluetooth version 1.1 or higher)*
- *Supported Bluetooth profiles:*
  - Headset profile
  - Hands-free profile

## Charge your headset

Charge the headset's battery fully before using the headset for the first time.

- 1 Plug the travel adapter into the jack on the headset.

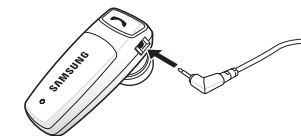

- 2 Plug the travel adapter into the electrical outlet.

- Charge the headset until the red light on the headset turns to blue.
- The headset will be fully charged in approximately 2 hours 30 minutes.

- 3 Remove the travel adapter from the headset.

- NOTES:**
- The headset cannot be used while charging.
  - Use only a Samsung-approved charger or adapter.

## Put your headset in pairing mode

Before you can use your headset, you must pair it with your phone.

- 1 Ensure that the headset is off (see Turn headset on/off on the reverse side of this guide).
- 2 Press and hold the Multi-Function button until the indicator light turns on in blue (approximately 8 seconds).

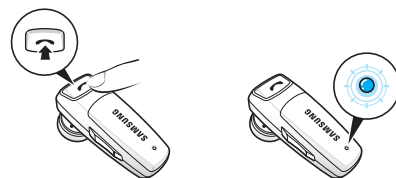

## Turn on Bluetooth on your phone and pair with headset

- 1 Set your Bluetooth phone to discover the headset by following your phone's guide.

Typically, the steps involve going to the Settings, Connection, or Bluetooth menu on your phone and then selecting the option to discover Bluetooth devices.

Your phone will find the Samsung WEP180 headset. your headset will be displayed as Samsung WEP 180/185.

- 2 Select your headset.
- 3 When the phone asks if you want to pair with it, confirm by selecting Yes or OK.
- 4 Enter the headset passkey or PIN, 0000.

## Test and use

Your phone and headset are now paired and ready to make and receive calls. To confirm they are operating properly, make a call:

- 1 Place the headset over your ear. See Wearing the headset on the reverse side of this guide.
- 2 On your phone, make a call to the number you want.
- 3 If your phone and headset are successfully paired, you will hear ringing on the headset.

After you have successfully paired your phone and headset, you do not need to repeat these initial setup steps each time you use the headset.

## Using your WEP180



See *Features and Functions Guide* on the reverse side of this guide for information on using your WEP180.

# Features and Functions Guide

## SAMSUNG Bluetooth® Headset WEP180

### ! Important:

Be sure to first follow the Quick Start Guide on the reverse side of this guide to complete initial setup of your headset.

- **Headquarters:**  
1301 East Lookout Drive Suite 150  
Richardson, TX 75082
- **Internet Address:**  
<http://www.samsungmobileusa.com/accessories>
- **Customer Care Center:**  
1-888-987-4357



## Turn the headset on/off

To turn the headset on,  
Press and hold the Multi-Function button for 4 seconds until you see 4 blue flashes on the indicator light, then release.  
You will hear a tone and see the indicator light flashes while the power is on (see Meaning of the indicator light of this guide).

To turn the headset off,  
Press and hold the Multi-Function button for 4 seconds until you see blue flashes on the indicator light, then release.  
You will hear series of 2 tones and see the indicator light stops flashing.

## Wear the headset

Wear the headset on your ear.  
In general, you will get better performance when there are no obstructions (including parts of your body) between the headset and the phone.



## Use the ear hook

Attach the supplied hook to the headset to make wearing the earpiece more comfortable.

Depending on which ear you are going to wear the headset, simply adjust the hook accordingly.

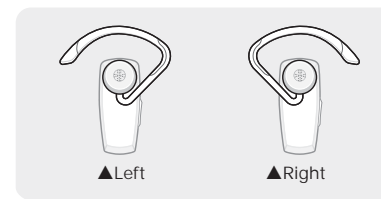

## Troubleshooting

My phone does not find my headset.  
Make sure the blue indicator light on your headset turns on when your phone is searching for devices.

My headset worked before but now it is not working.  
Make sure your phone is on and the Bluetooth feature is turned on in your phone.  
If the Bluetooth feature has been turned off or was turned on only temporarily, you may need to restart the Bluetooth feature.  
If you have confirmed the Bluetooth feature is on in your phone, pair your phone and headset again.

## Make calls

Make a voice activated call

If the phone's voice recognition feature is on, you can make a voice activated call.

- 1 Press the Multi-Function button once. You will hear the voice-activation tone.
- 2 Say the name of the person you wish to call.

Depending on your phone, this feature may not be supported.

Redial the last number

When the headset is connected with the phone via the Hands-free profile, press and hold the Multi-Function button.

When the headset is connected with the phone via the Headset profile:

- 1 Press the Multi-Function button to access the recent call list.

- 2 If necessary, press [▲] or [▼] to scroll to the number you want.
- 3 Press the Multi-Function button to dial the selected number.

End a call

Press the Multi-Function button.

Answer a call

When a call comes in, the headset sounds the ring tone and flashes the blue indicator twice. Press the Multi-Function button.

Adjust the volume

Press [▲] on the side of the headset to increase the volume level and press [▼] to decrease the volume level.

## Use enhanced features

Enhanced features are available for phones that support the hands-free Bluetooth profile and enhanced features.

- **Reject a call**  
When you receive a call, press and hold the Multi-Function button to reject the call. Depending on your phone's setting or type, this feature may not be supported.
- **Answer a second call**  
When your phone notifies you of another incoming call while you are on a call, press and hold the Multi-Function button. You can switch between calls by pressing and holding it again. Depending on your phone, this feature may not be supported.
- **Place a call on hold**  
While you are on a call, press and hold the Multi-Function button.  
To retrieve the call, press and hold the Multi-Function button again.  
Depending on your phone, this feature may not be supported.

## Meaning of the indicator light

Light	Tone	Status
Flashes in blue every 8 seconds.	Quick series of 2 tones. (Active mode starts.)	The headset is in Active mode. <ul style="list-style-type: none"><li>• The headset has an active call in progress.</li><li>• You can talk up to 6 hours.</li></ul>
Flashes in blue every 3 seconds.	Quick series of 2 tones. (Standby mode starts.)	The headset is in Standby mode. <ul style="list-style-type: none"><li>• The headset is waiting for a call.</li><li>• The headset can be in Standby mode up to 110 hours.*</li></ul>
Flashes in red instead of blue.	5 tones every 20 seconds.	The battery of the headset is low. <ul style="list-style-type: none"><li>• There is less than 10% of battery power left. Recharge the battery.</li></ul>

\*Depending on the phone type and usage, the actual time may vary.

## Free Manuals Download Website

<http://myh66.com>

<http://usermanuals.us>

<http://www.somanuals.com>

<http://www.4manuals.cc>

<http://www.manual-lib.com>

<http://www.404manual.com>

<http://www.luxmanual.com>

<http://aubethermostatmanual.com>

Golf course search by state

<http://golfingnear.com>

Email search by domain

<http://emailbydomain.com>

Auto manuals search

<http://auto.somanuals.com>

TV manuals search

<http://tv.somanuals.com>