



**Earn BISSELL Rewards!**

Register your product today!  
See details on back page

# LIFT-off<sup>®</sup> STEAM MOP™

USER'S GUIDE  
39W7 SERIES

- 2 Thank You
- 3 Safety Instructions
- 4 Product View
- 5 Assembly
- 6-8 Operations
- 9 Maintenance and Care
- 10 Troubleshooting
- 10 Replacement Parts
- 10 Accessories
- 11 Warranty
- 12 Product Registration
- 12 Consumer Services



# Thanks for buying a BISSELL Lift-Off Steam Mop

We're glad you purchased a BISSELL Lift-Off Steam Mop. Everything we know about floor care went into the design and construction of this complete, high-tech home cleaning system.

Your BISSELL Lift-Off Steam Mop is well made, and we back it with a limited two year warranty. We also stand behind it with a knowledgeable, dedicated Consumer Services department, so, should you ever have a problem, you'll receive fast, considerate assistance.

My great-grandfather invented the floor sweeper in 1876. Today, BISSELL is a global leader in the design, manufacture, and service of high quality homecare products like your BISSELL Lift-Off Steam Mop .

Thanks again, from all of us at BISSELL.

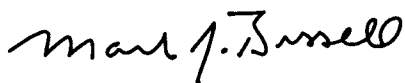

Mark J. Bissell  
Chairman, President & CEO

## DETACHABLE INNOVATION

### Complete Line of BISSELL Lift-Off® Products



Lift-Off®  
Steam Mop



Lift-Off®  
Deep Cleaner



Lift-Off®  
Multi Cyclonic  
Vacuum



Lift-Off®  
Floors & More  
Cordless Stick Vacuum

For more information visit [www.bissell.com](http://www.bissell.com)

# IMPORTANT SAFETY INSTRUCTIONS

## When using an electrical appliance, basic precautions should be observed, including the following:

Read all instructions before using your Lift-Off Steam Mop.

**⚠ WARNING:** To reduce the risk of fire, electric shock, or injury:

- Do not direct steam at people, animals, or at electrical outlets.
- Do not expose to rain.
- Store indoors.
- Unplug from outlet when not in use and before conducting maintenance or troubleshooting.
- Do not leave steam cleaner unattended.
- Do not expose hair, loose clothing, fingers or body parts to openings or moving parts.
- Do not service steam cleaner when it is plugged in.
- Do not handle steam cleaner with wet hands.
- Do not use steam cleaner if it has been dropped, damaged, left outdoors or dropped into water, return it to a service center.
- Do not pull or carry by cord, use cord as a handle, close door on cord, pull cord around sharp corners or edges, or expose cord to heated surfaces.
- Do not unplug by pulling on cord.
- Do not use appliance in an enclosed space filled with vapor given off by oil-base paint, paint thinner, some moth proofing substances, flammable dust, or other explosive or toxic vapors.
- Do not allow to be used as a toy.
- Do not use on leather, wax polished furniture or floors, synthetic fabrics, velvet or other delicate, steam-sensitive materials.
- Do not immerse.
- Do not use for any purpose other than described in this User's Guide.
- Use only manufacturer's recommended attachments - use of attachments not provided or sold by BISSELL may cause fire, electric shock or injury.
- Never put descaling, aromatic, (not including the BISSELL Eucalyptus Mint Natural Aroma, water products), alcoholic or detergent products into the steam cleaner, as this may damage it or make it unsafe for use.
- Unplug by grasping the plug, not the cord.

- Close attention is necessary when used by or near children.
- Do not attempt to use without water in the tank.
- Do not put any object into appliance openings; or use with blocked opening.

## SAVE THESE INSTRUCTIONS

Commercial use of this unit void the manufacturer's warranty.

## GROUNDING INSTRUCTIONS

This appliance must be connected to a grounded wiring system. If it should malfunction or break down, grounding provides a safe path of least resistance for electrical current, reducing the risk of electrical shock. The cord for this appliance has an equipment-grounding conductor and a grounding plug. It must only be plugged into an outlet that is properly installed and grounded in accordance with all local codes and ordinances.

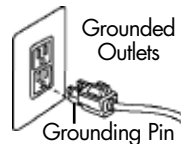

## ⚠ WARNING:

Improper connection of the equipment-grounding conductor can result in a risk of electrical shock. Check with a qualified electrician or service person if you aren't sure if the outlet is properly grounded. **DO NOT MODIFY THE PLUG.** If it will not fit the outlet, have a proper outlet installed by a qualified electrician. This appliance is designed for use on a nominal 120-volt circuit, and has a grounding attachment plug that looks like the plug in the drawing above. Make certain that the appliance is connected to an outlet having the same configuration as the plug. No plug adapter should be used with this appliance.

This model is for household use only.

3

## Product view



## Optional Accessories:



Mop Pads - 2 pack



Water Purification System



Steam Mop Scented Water-Eucalyptus Mint

# Assembly

Your Lift-Off Steam Mop assembles quickly and easily. The only thing you will need for assembly is a Phillips head screwdriver.

Your Lift-Off Steam Mop is packaged with the following items:

**Handle Assembly**

**Lower Body base**

**Detachable Steam Pod with water purification**

**Maneuverable Swivel Head**

**Removable Water Tank**

**1 small Phillips Head Screw taped to the handle**

**2 Deluxe Mop Pads**

1. Attach lower body base to maneuverable swivel head.
2. Secure maneuverable swivel head with small Phillips head screw. Tighten until secure.
3. Slide handle assembly down into lower body base until it will go no further. Secure the handle by turning the knob until tight

Lift-Off Steam Mop assembly is now complete.

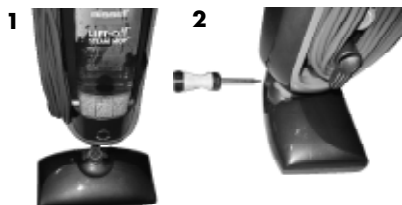
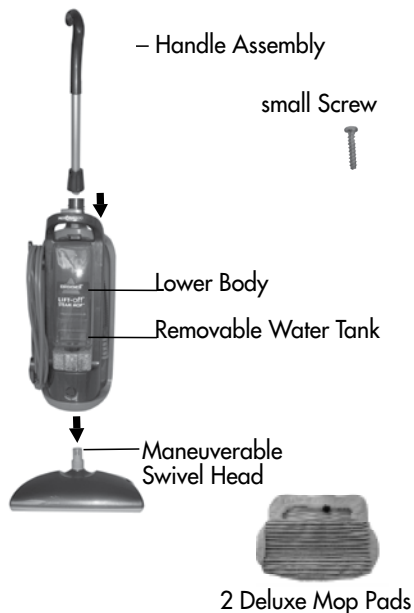

# Operations

## **Features and accessories**

### **Removable water tank**

The water tank is located on the front of the Lift-Off Steam Mop. It can be refilled with water any time during use. Distilled or demineralized water may be used in place of tap water.

**Do not use chemicals with your Lift-Off Steam Mop (not including BISSELL Eucalyptus Mint Natural and water product.**

### **Water purification system**

This filter removes minerals and other impurities from tap water, preventing water deposits from damaging your Lift-Off Steam Mop. It should be replaced when the bright green grains turn blue. To maximize performance of the filter, distilled water may be used.

### **Ready light**

The ready light will glow when the Lift-Off Steam Mop is ready to use.

### **Steam on demand trigger**

Press to release steam.

### **Maneuverable swivel head**

Use to clean around furniture and hard to reach areas on the floor.

### **Mop pads**

Reuseable microfiber mop pad is machine washable and safe for all hard floor surfaces.

### **Circular scrubbing brush tool**

Attach to end of the hose for scrubbing stubborn soil and hard to reach areas. Color coded for specific use. Red for bathrooms and black for the kitchen.

### **Grout brush tool**

Attach to end of the hose for scrubbing small cracks and crevices.

### **Flat surface Microfiber pad cleaning tool**

Attach flat surface with pad to the end of the adapter. Attach to the end of the hose for cleaning large flat surfaces.

*Tip:*

Do not attempt to use your Lift-Off Steam Mop without water in the tank.



## **CAUTION:**

Thermal shock can shatter glass. Before cleaning cold glass surfaces, carefully warm the surface by directing the steam jet on the glass from a distance at no less than four to six inches.

# Operations

## Getting ready

1. Attach mop pad
  - A. Set the mop pad flat on the floor
  - B. Line up the mop head and place it inside the mop pad with cord located at rear of mop head. Tighten cord to ensure tight fit.
2. Fill water tank
  - A. Remove tank by lifting straight up and away from the unit.
  - B. Unscrew cap and remove from tank.
  - C. Fill water tank with water. For best results, water should be at room temperature.
  - D. Replace the assembly cap and tighten until snug.
  - E. Replace water tank by lining up vertical guides and gently sliding tank into place.
3. Select a steam control setting. Light is for delicate floors such as hardwood and laminates. Medium is for everyday cleaning, and Tough is for hard to clean messes.
4. Twist the quick release cord wrap clockwise to unwrap the power cord completely and plug into a 120-Volt grounded outlet as described on the Important Safety Instructions, page 3.
5. The ready light will illuminate in 30 seconds when the Lift-Off Steam Mop is ready for use.

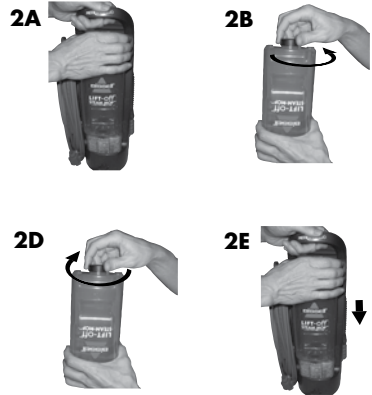

## Before you clean

**Thoroughly sweep or vacuum floor prior to cleaning with the Lift-Off Steam Mop.**

## Cleaning hard floors

**Your Lift-Off Steam Mop is designed to clean hard flooring such as ceramic tile, vinyl, laminate, marble, stone and sealed hard wood floors. Use of your Lift-Off Steam Mop on waxed or some unwaxed floors may result in a diminished glossiness. The Lift-Off Steam Mop is not for use on unsealed wood floors. For best results test in an inconspicuous area and check the care instructions from your flooring manufacturer.**

# Operations

## Cleaning hard floors continued

1. When the ready light illuminates, begin cleaning by slowly passing over surface while pressing the steam on demand trigger to emit steam as needed.
2. To sanitize an area of your floor, (attack invisible germs and bacteria) place the center of the Lift-Off Steam Mop over the spot for a minimum 15 seconds, but no longer than 20 seconds. For larger areas, overlap swivel head placement.
3. When the Lift-Off Steam Mop stops emitting steam, simply remove the water tank, refill, and continue cleaning.

**NOTE: upon first use of this steam product or first use of a new filter, the pump may make a "knocking" sound while the filter fills with water. This sound is normal and may last up to one minute. Continue to depress the trigger until the knocking sound subsides and the unit emits steam.**

## Steam cleaning all living areas

**Stubborn messes that resist traditional water and cleaning solutions can be removed with steam. Toothpaste or hair spray on the bathroom sink, soap scum on sliding shower walls—steam makes all these far easier to clean.**

1. Fill the water tank with cool tap water or distilled/demineralized water and replace back on Detachable Steam Pod.
2. Remove Steam Pod by pressing the pod release button on the top of the carry handle and pulling the pod out and away from the lower base.
3. Remove cord from pod and connect the plug to an appropriate outlet.
4. Remove hose from pod by pressing the clip at the end of the hose where it connects to the detachable pod.
5. Connect desired tool to the end of the hose.
6. When blue ready light turns on, the steamer is ready to use.
7. To activate steam, press the pod release button on the top of the carry handle. To stop steaming, release the pod release button.



## **WARNING:**

Never put descaling, aromatic (not including the BISSELL Eucalyptus Mint water product), alcoholic or detergent product) into the steam cleaner, as this may damage it or make it unsafe for use.

### *Tip:*

During first use, it may take several seconds for the Lift-Off Steam Mop to begin steaming. The water needs to flow through the filter to the heater. This delay will only occur during initial use or when using a new filter.



# Maintenance and care

## When you're done

1. Unplug power cord from outlet.
2. Carefully remove mop pad from swivel head, as mop pad and lower assembly will be hot.
3. Any water remaining in the water tank should be emptied prior to machine storage.
4. Mop pad can be machine washed in warm water. Use only liquid detergents. Do not use bleach or fabric softeners; for best results, air dry.
5. Wrap power cord around quick release cord wrap on side of Detachable Steam Pod.



## **CAUTION:**

Upright storage of the Lift-Off Steam Mop with a wet mop pad may result in the formation of white marks on your floor. To remove the white marks, clean area with vinegar.

## Replacing the water purification system

**If you fill your Lift-Off Steam Mop cleaner with normal tap water, it is essential to check the water purification system and replace it when it is no longer effective. Change the filter when the bright green grains turn blue. If the filter is not changed at the appropriate time, calcium deposits will accumulate on the heating element, causing damage or reduced performance.**

**Using distilled or demineralized water will maximize the performance of your filter.**

**To order a replacement water purification system, refer to the replacement parts section on page 10.**

### *Tip:*

Using distilled or demineralized water will maximize the performance of your filter.

### *Tip:*

Be sure to use only a BISSELL water filter in your Lift-Off Steam Mop.

# Troubleshooting

## Reduced steam or no steam.

### Possible Causes

1. Water tank empty
2. Depleted water filter

### Remedies

1. Fill tank
2. Replace filter

Other maintenance or service not included in the manual should be performed by an authorized service representative.

Thank you for selecting a BISSELL product.

**Please do not return this product to the store.**

For any questions or concerns, BISSELL is happy to be of service. Contact us directly at 1-800-237-7691.

## Replacement parts- BISSELL Lift-Off Steam Mop

Item	Part No.	Part Name
1	3252-2	Water Filter
2	203-2275	Water Tank with Cap and Insert
3	203-2276	Cap and Insert Assembly
4	203-2274	White Flat Surface Pad



## Accessories

These items are available for purchase as accessories for your BISSELL Lift-Off Steam Mop: To purchase call 1-800-237-7691 or visit [www.bissell.com](http://www.bissell.com).

Item	Part No.	Part Name
1	71X9	Microfiber Mop Pads - 2 pack
2	3252-1	Eucalyptus Mint Natural Aroma
3	59V4	Steam Mop Scented Water Eucalyptus Mint 32 FL oz



# Warranty BISSELL Lift-Off Steam Mop

This warranty gives you specific legal rights, and you may also have other rights that may vary from state to state. If you need additional instruction regarding this warranty or have questions regarding what it may cover, please contact BISSELL Consumer Services by E-mail, telephone, or regular mail as described below.

## Limited Two Year Warranty

Subject to the \*EXCEPTIONS AND EXCLUSIONS identified below, upon receipt of the product BISSELL Homecare, Inc. will repair or replace (with new or remanufactured components or products), at BISSELL's option, free of charge from the date of purchase by the original

purchaser, for one year any defective or malfunctioning part.

See information below on "If your BISSELL product should require service".

This warranty applies to product used for personal, and not commercial or rental service. This warranty does not apply to fans or routine maintenance components such as filters, belts, or brushes. Damage or malfunction caused by negligence, abuse, neglect, unauthorized repair, or any other use not in accordance with the User's Guide is not covered.

## If your BISSELL product should require service:

Contact BISSELL Consumer Services to locate a BISSELL Authorized Service Center in your area.

If you need information about repairs or replacement parts, or if you have questions about your warranty, contact BISSELL Consumer Services.

### Website or E-mail:

[www.bissell.com](http://www.bissell.com)

### Or Call:

BISSELL Consumer Services

1-800-237-7691

Monday - Friday 8 a.m. - 10 p.m. ET

Saturday 9 a.m. - 8 p.m. ET

### Or Write:

BISSELL Homecare, Inc.

PO Box 3606

Grand Rapids, MI 49501

ATTN: Consumer Services

BISSELL HOME CARE, INC. IS NOT LIABLE FOR INCIDENTAL OR CONSEQUENTIAL DAMAGES OF ANY NATURE ASSOCIATED WITH THE USE OF THIS PRODUCT. BISSELL'S LIABILITY WILL NOT EXCEED THE PURCHASE PRICE OF THE PRODUCT.

**Some states do not allow the exclusion or limitation of incidental or consequential damages, so the above limitation or exclusion may not apply to you.**

**\*EXCEPTIONS AND EXCLUSIONS FROM THE TERMS OF THE LIMITED WARRANTY**  
THIS WARRANTY IS EXCLUSIVE AND IN LIEU OF ANY OTHER WARRANTIES EITHER ORAL OR WRITTEN. ANY IMPLIED WARRANTIES WHICH MAY ARISE BY OPERATION OF LAW, INCLUDING THE IMPLIED WARRANTIES OF MERCHANTABILITY AND FITNESS FOR A PARTICULAR PURPOSE, ARE LIMITED TO THE ONE YEAR DURATION FROM THE DATE OF PURCHASE AS DESCRIBED ABOVE.

Some states do not allow limitations on how long an implied warranty last so the above limitation may not apply to you.

**NOTE: Please keep your original sales receipt. It provides proof of date of purchase in the event of a warranty claim.**

## Don't forget to register your product!

Registering is quick, easy and offers you benefits over the lifetime of your product. You'll receive:

### **BISSELL Rewards Points**

Automatically earn points for discounts and free shipping on future purchases.

### **Faster Service**

Supplying your information now saves you time should you need to contact us with questions regarding your product.

### **Product Support Reminders and Alerts**

We'll contact you with any important product maintenance reminders and alerts.

### **Special Promotions**

Optional: Register your email to receive notice of offers, contests, cleaning tips and more!

**Visit [www.bissell.com/registration](http://www.bissell.com/registration) now!**

## BISSELL consumer services

For information about repairs or replacement parts, or questions about your warranty, call:

### **BISSELL Consumer Services**

**1-800-237-7691**

Monday - Friday 8 a.m. — 10 p.m. ET

Saturday 9 a.m. — 8 p.m. ET

Or write:

BISSELL Homecare, Inc.

PO Box 3606

Grand Rapids MI 49501

ATTN: Consumer Services

Or visit the BISSELL website - **[www.bissell.com](http://www.bissell.com)**

When contacting BISSELL, have model number of cleaner available.

Please record your Model Number: \_\_\_\_\_

Please record your Purchase Date: \_\_\_\_\_

**NOTE: Please keep your original sales receipt. It provides proof of purchase date in the event of a warranty claim. See Warranty on page 11 for details.**



©2011 BISSELL Homecare, Inc.  
Grand Rapids, Michigan  
All rights reserved. Printed in China  
Part Number 120-4366  
Rev 6/11  
Visit our website at:  
[www.bissell.com](http://www.bissell.com)

## Free Manuals Download Website

<http://myh66.com>

<http://usermanuals.us>

<http://www.somanuals.com>

<http://www.4manuals.cc>

<http://www.manual-lib.com>

<http://www.404manual.com>

<http://www.luxmanual.com>

<http://aubethermostatmanual.com>

Golf course search by state

<http://golfingnear.com>

Email search by domain

<http://emailbydomain.com>

Auto manuals search

<http://auto.somanuals.com>

TV manuals search

<http://tv.somanuals.com>