

# BISSELL®

**WE MEAN CLEAN**

## **POWERgroom®**

**MULTI CYCLONIC  
USER'S GUIDE  
80Q2 SERIES**

- 2 Thank You
- 3 Safety Instructions
- 4 Product View
- 5 Assembly
- 6-8 Operations
- 9-12 Maintenance and Care
- 13 Troubleshooting
- 14 Replacement Parts
- 15 Warranty
- 16 Consumer Services



## **Thanks for buying a BISSELL Vacuum**

We're glad you purchased a BISSELL PowerGroom Multi Cyclonic vacuum. Everything we know about floor care went into the design and construction of this complete, high-tech home cleaning system.

Your BISSELL PowerGroom Multi Cyclonic canister vacuum is well made, and we back it with a limited one year warranty. We also stand behind it with a knowledgeable, dedicated Consumer Services department, so, should you ever have a problem, you'll receive fast, considerate assistance.

My great-grandfather invented the floor sweeper in 1876. Today, BISSELL is a global leader in the design, manufacture, and service of high quality homecare products like your BISSELL PowerGroom Multi Cyclonic canister vacuum.

Thanks again, from all of us at BISSELL.

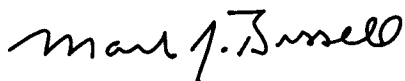

**Mark J. Bissell**  
Chairman & CEO

# IMPORTANT SAFETY INSTRUCTIONS

When using an electrical appliance, basic precautions should be observed, including the following:

## READ ALL INSTRUCTIONS BEFORE USING YOUR CANISTER VACUUM.

### **WARNING: To reduce the risk of fire, electric shock, or injury:**

- Unplug from outlet when not in use.
- Do not use outdoors or on wet surfaces.
- Use indoors only.
- For dry pick up only.
- Do not leave machine when it is plugged in.
- Do not use with damaged cord or plug.
- If appliance is not working as it should, has been dropped, damaged, left outdoors, or dropped into water, return it to a service agent.
- Do not pull or carry by cord, use cord as a handle, close door on cord, pull cord around sharp corners or edges or run appliance over cord. Keep cord away from heated surfaces.
- Do not unplug by pulling on cord. Unplug by grasping plug.
- Do not run appliance over cord.
- Keep cord away from heated surfaces.
- Do not handle plug or appliance with wet hands.
- Hold plug when rewinding onto cord reel.
- Do not allow plug to whip when rewinding.
- Do not expose hair, loose clothing, fingers or body parts to openings or moving parts.
- Do not pick up hot or burning objects such as cigarettes, matches, or hot ashes.
- Do not pick up flammable or combustible materials (lighter fluid, gasoline, kerosene, etc.) or use in the presence of explosive liquids or vapor.
- Not intended for use by persons (including children) with reduced physical, sensory or mental capabilities, or lack of experience and knowledge, unless they have been given supervision or instruction concerning use of the appliance by a person responsible for their safety.

- Young children should be supervised to ensure that they do not play with the appliance.
- Remove plug from electrical outlet before cleaning or maintaining the appliance.
- If the supply cord is damaged, it must be replaced by the manufacturer or its service agent in order to avoid a hazard.
- Do not pick up toxic material (chlorine bleach, ammonia, drain cleaner, petrol, etc.).
- Do not use for any purpose other than described in this User's Guide.
- Use only manufacturer's recommended attachments.
- Do not use with any opening blocked; keep free of dust, lint, hair, and anything that may reduce air flow. Do not put any object into the opening.
- Keep appliance on a level surface.
- Turn off all controls before unplugging.
- Be extra careful when cleaning stairs.
- Do not use without the dirt cup or a dust bag and filters in place.
- Do not allow to be used as a toy.

## SAVE THESE INSTRUCTIONS FOR FUTURE USE

This model is for household use only.

## THIS APPLIANCE HAS A POLARIZED PLUG.

To reduce the risk of electric shock, this appliance has a polarized plug (one blade is wider than the other). This plug will fit in a polarized outlet only one way. If the plug does not fit fully in the outlet, reverse the plug. If it still does not fit, contact a qualified electrician to install a proper outlet. Do not change the plug in any way.

# Product view



Upholstery Tool



Crevice Tool



Dusting Brush



## CAUTION:

Do not plug in your vacuum until you are familiar with all instructions and operating procedures.

## Assembly

1. Connect the hose to the vacuum by inserting the hose connector into the suction opening on the bottom front of the vacuum. Push in until it clicks into the locked position.
2. Connect the telescoping extension wand to the handle end of the hose.
3. Connect the floor nozzle foot onto the telescoping extension wand.
4. Attach the tool holder onto the top portion of the extension wand. Place the tools onto the tool holder for storage.
5. To extend the telescoping extension wand, push the black release button and then pull the bottom of the wand to the desired length.
6. Once assembled, you can store your vacuum by inserting the storage clip (located on the back of the floor nozzle) into the storage slot on the rear of the vacuum.

**NOTE: Shorten the length of the telescoping extension wand for storage.**

### **WARNING:**

Plastic film can be dangerous. To avoid danger of suffocation, keep away from babies and children.

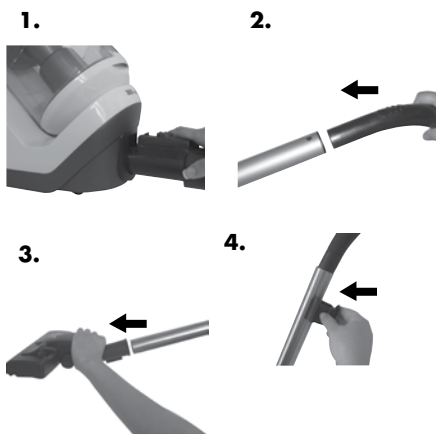

# Operations

## Power cord

The power cord is located at the rear of the vacuum. Gently pull out the power cord, watching for the yellow line. Stop pulling the power cord once the yellow line is visible. There is also a red line, which indicates the end of the usable cord. Do not pull the power cord out beyond the red line.

## Automatic cord rewind

Your vacuum is equipped with an automatic cord rewind. When cleaning is finished, press the power button OFF (⊖) and grasp the plug to disconnect from the electrical outlet. Hold the plug and press the automatic cord rewind button to rewind the cord automatically.



Automatic Cord Rewind Button

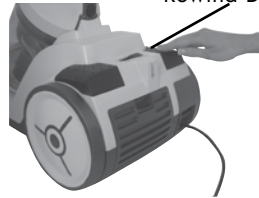

## **CAUTION:**

Be careful to avoid injury as cord retracts very quickly.

# Operations

## **Power button**

Turn the power ON or OFF by pressing lightly downward on the power button (ⓘ).

## **Variable suction power control**

The variable suction power control is located on the back of the vacuum. Turn the control toward the larger dots for maximum suction. Turn the control toward the smaller dots to minimize suction for lightly soiled areas or delicate fabrics.

## **Air flow regulator**

Open the air flow regulator by sliding the regulator back towards the handle to an open position. This will reduce the suction power for vacuuming delicate fabrics.

For full suction power, close the air flow regulator by sliding the regulator forward to the closed position.

Power Button

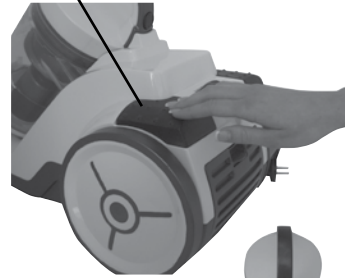

Variable Suction Control



### *Tip:*

Use the variable suction power control and the air flow regulator to reduce air flow as needed when using the tools.



## **CAUTION:**

Before using your vacuum, make sure that the dirt container and all filters (pre-motor and post-motor) are in place. Do not operate your vacuum without the dirt container and filters.



# Operations

## Special tools

Your **BISSELL PowerGrooom Multi Cyclonic** is not only a powerful carpet and rug vacuum cleaner, it's also a versatile bare floor and above floor vacuum cleaner when you select one of the special tools.

### Floor nozzle:

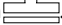
Use to vacuum carpets, rugs and bare floors. Swivel head turns to get into tight spaces and fits under cabinets.

1. To vacuum carpets and rugs, push the brush switch to the carpet position . This will pull the brushes up into the floor nozzle.
2. To vacuum bare floors, push the brush switch to the bare floor position . This will extend the brushes down from the floor nozzle.

### Upholstery tool:

Use the upholstery tool to clean curtains, draperies, cushions and fabrics.

### Crevice tool:

Use the crevice tool in tight, narrow spaces.

### Dusting brush:

Use the dusting brush to dust furniture, blinds, books, lamps, shelves and baseboards.





# Maintenance and care

## Emptying the dirt container

**Empty the dirt container as soon as the dirt reached the "FULL" lines on the sides of the dirt container.**

1. Unplug the vacuum from the electrical outlet.
2. Press the dirt container release button located on the back of the carry handle and lift up to remove.
3. Choose an emptying method. Method #2 is recommended for allergy sufferers.

**Method #1** – Hold the dirt container over a trash can and push the emptying button located on the back bottom of the dirt container to open the bottom. Close the bottom after the dirt empties and make sure it clicks back into the locked position.

**Method #2** – Place a plastic bag over the bottom of the dirt container. Push the emptying button, located on the back bottom of the dirt container, through the plastic to open the bottom. After the dust settles, remove the plastic bag to discard. Close the bottom and make sure it clicks back into the locked position.



## **WARNING:**

To reduce the risk of electric shock, turn power switch OFF and disconnect plug from electrical outlet before performing maintenance or troubleshooting checks.

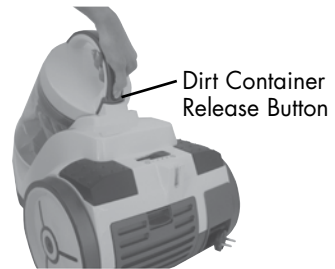

# Maintenance and care

## **Cleaning the inner cyclone & screen**

**Filters protect the motor from dirt and dust particles. Use only BISSELL replacement filters in your PowerGroom Multi Cyclonic**

1. Unplug the vacuum from the electrical outlet.
2. Remove the dirt container from the vacuum and make sure it is empty.
3. Remove the top portion of the dirt container by grasping the carry handle and turning counter clockwise and pulling up and out of the dirt container.
4. Remove the inner cyclone by grasping the bottom of the cyclone and turning counter clockwise to unlock. Pull straight down to remove. Clean with a cloth to remove dust and debris
5. Remove the screen by pulling straight down. Clean with a cloth or a soft brush to remove dust and debris.
6. The tank may also be wiped clean with a damp cloth. Make sure the tank is completely dry before reassembling.
7. To reassemble, hold the carry handle and place the screen back onto the top portion of the dirt container. Be sure to align the notch on the top with the insert on the flat edge of the screen. Then place the inner cyclone back into the screen by aligning the notches at the top of the inner cyclone with the inserts inside the screen and turning clockwise to lock into place.
8. Place the top portion back onto the dirt container by grasping the carry handle and turning clockwise to lock into place. Be sure that the dirt container release button is aligned with the emptying button when locked into place.

3.



4.

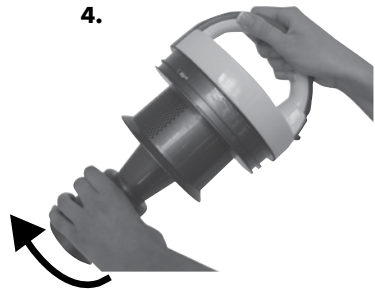

5.

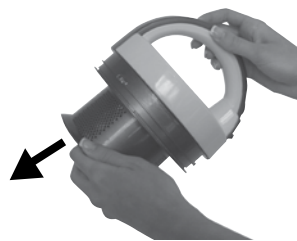

# Maintenance and care

## Cleaning the pre-motor filter

**The pre-motor filter protects the motor from dirt and dust particles. Use only BISSELL replacement filters in your PowerGroom Multi Cyclonic.**

1. Turn the power OFF. Unplug the vacuum from the electrical outlet.
2. Remove the dirt container from the vacuum.
3. The pre-motor filter is located behind the door labeled "FILTER" on the main body of the vacuum. Open the door by pushing up on the tab at the bottom of the door and pulling out to remove.
4. Remove the filter tray by pulling up on the tab of the tray. Remove the pre-motor filter and set aside. Tap the tray gently over a trash can to remove any dirt or debris.
5. The pre-motor filter can be washed in cold water with a mild detergent. Rinse well and air dry thoroughly before placing back into the tray.
6. Place the tray back into the vacuum and replace the filter door by inserting the tabs at the top of the door and pushing down until it clicks into the locked position.

## **NOTICE:**

This product is intended for household use only and not for commercial or industrial use. Vacuuming of dust from products like plaster, concrete or ashes will damage the motor and void the warranty.

4.



4.

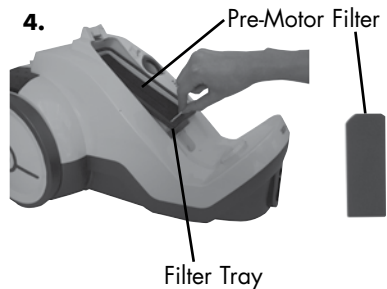

### *Tip:*

For maximum cleaning performance, check the filters often and clean or replace if necessary.



## **WARNING:**

Do not operate cleaner with damp or wet filters or without all filters in place.

# Maintenance and care

## Replacing the Post-motor HEPA Media Filter\*

**The post-motor HEPA Media Filter\* assists in the filtration process to return clean air to the room. Use only BISSELL replacement filters in your PowerGroom Multi Cyclonic.**

1. Turn the power OFF. Unplug the vacuum from the electrical outlet.
2. The post-motor filter is located behind the door labeled "FILTER" on the rear of the vacuum. Open the door by pushing down on the tab of the door and pulling out to remove.
3. Remove the post-motor HEPA Media Filter\* by grasping the handle on the filter and pulling out to remove.
4. Replace the post-motor HEPA Media Filter\* with a new filter.  
**NOTE: The post-motor filter is a white, pleated HEPA Media Filter\*. This filter is NOT washable and must be replaced when it becomes dirty.**
5. Replace the filter door by inserting the two tabs at the bottom of the filter door. Then push down on the tab on the door and push it back into the vacuum. Release the tab on the door to lock into place.

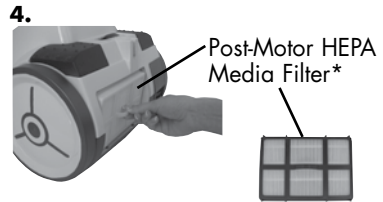
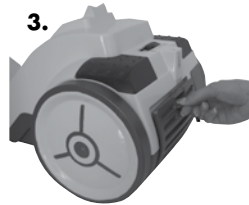

\*The filter media, not the vacuum as a whole, complies with the IESTRP-CC001.5 or the EN-1822-1:2009 HEPA standard.

## Thermal protector

**An internal thermal protector has been designed into your vacuum to protect it from overheating. When the thermal protector activates, the vacuum motor will stop operating. If this happens:**

1. Turn the cleaner OFF (O) and unplug from electrical outlet.
2. Empty dirt container, check filters and air passages for dirt accumulation.
3. The thermal protector automatically resets after approximately 2 hours. If the thermal protector does not reset, call BISSELL Consumer Services or visit the website.

# Troubleshooting



## **WARNING:**

To reduce the risk of electric shock, turn power OFF and disconnect plug from electrical outlet before performing maintenance or troubleshooting.

### **Vacuum cleaner won't run**

#### **Possible causes**

1. Vacuum cleaner is not plugged in
2. Power button is not pressed down
3. Thermal protector activated

#### **Remedies**

1. Check electrical plug
2. Press power button down
3. Allow cleaner to cool for 2 hours. See page 12.

### **Vacuum cleaner won't pick up or low suction**

#### **Possible causes**

1. Tools, hose and/or telescoping extension wands are blocked
2. Filters are dirty
3. Dirt container is full
4. Hose not securely attached to suction opening
5. Crack or hole in flex hose
6. Air flow regulator or variable suction power control is set to open or minimum setting

#### **Remedies**

1. Remove each part and check for blockages
2. Check and clean or replace pre-motor and post-motor filters
3. Empty dirt container
4. Make sure hose connector is locked into suction opening
5. Check hose and replace if needed
6. Change to closed or maximum setting

### **Visible dust escaping from vacuum**

#### **Possible causes**

1. Dirt container is full
2. Filters missing or installed incorrectly
3. Filters are dirty
4. Flex hose is blocked
5. Hose not securely attached to suction opening
6. Crack or hole in flex hose

#### **Remedies**

1. Empty dirt container
2. Check pre-motor and post-motor filter for correct installation
3. Check and clean or replace pre-motor and post-motor filters
4. Remove hose and check for blockages
5. Make sure hose connector is locked into suction opening
6. Check hose and replace if needed

**Other maintenance or service not included in the manual should be performed by an authorized service representative.**

**Thank you for selecting a BISSELL product.**

**Please do not return this product to the store.**

**For any questions or concerns, BISSELL is happy to be of service. Contact us directly at 1-800-237-7691.**

# Replacement parts - BISSELL vacuum

Item	Part No.	Part Name
1	203-1578	Hose
2	203-1579	Telescoping Extension Wand
3	203-1536	Multi-Surface Floor Nozzle
4	203-1583	Tool Holder
5	203-1581	Upholstery Tool
6	203-1580	Crevice Tool
7	203-1582	Dusting Brush
8	203-1575	Inner Cyclonic Assembly
9	203-1569	Pre-Motor Filter
10	203-1557	Post-Motor HEPA Media Filter*

1



2



3



4



5



6



7



8



9



10

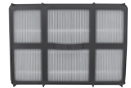

\*The filter media, not the vacuum as a whole, complies with the IEST-RP-CC001.5 or the EN-1822-1:2009 HEPA standard.



# Warranty - BISSELL PowerGroom® Multi Cyclonic Vacuum

This warranty gives you specific legal rights, and you may also have other rights which may vary from state to state. If you need additional instruction regarding this warranty or have questions regarding what it may cover, please contact BISSELL Consumer Services by E-mail, telephone, or regular mail as described below.

## Limited One Year Warranty

Subject to the \*EXCEPTIONS AND EXCLUSIONS identified below, upon receipt of the product BISSELL will repair or replace (with new or remanufactured components or products), at BISSELL's option, free of charge from the date of purchase by the original purchaser, for one year any defective or malfunctioning part.

See information below on "If your BISSELL product should require service".

This warranty applies to product used for personal, and not commercial or rental service. This warranty does not apply to fans or routine maintenance components such as filters, belts, or brushes. Damage or malfunction caused by negligence, abuse, neglect, unauthorized repair, or any other use not in accordance with the User's Guide is not covered.

## If your BISSELL product should require service:

Contact BISSELL Consumer Services to locate a BISSELL Authorized Service Center in your area.

If you need information about repairs or replacement parts, or if you have questions about your warranty, contact BISSELL Consumer Services.

### Website or E-mail:

[www.bissell.com](http://www.bissell.com)

Use the "Customer Support" tab.

### Or Call:

BISSELL Consumer Services

1-800-237-7691

Monday – Friday 8 am -10 pm ET

Saturday 9 am - 8 pm ET

### Or Write:

BISSELL Homecare, Inc.

PO Box 3606

Grand Rapids, MI 49501

ATTN: Consumer Services

BISSELL IS NOT LIABLE FOR INCIDENTAL OR CONSEQUENTIAL DAMAGES OF ANY NATURE ASSOCIATED WITH THE USE OF THIS PRODUCT. BISSELL'S LIABILITY WILL NOT EXCEED THE PURCHASE PRICE OF THE PRODUCT.

**Some states do not allow the exclusion or limitation of incidental or consequential damages, so the above limitation or exclusion may not apply to you.**

### \*EXCEPTIONS AND EXCLUSIONS FROM THE TERMS OF THE LIMITED WARRANTY

THIS WARRANTY IS EXCLUSIVE AND IN LIEU OF ANY OTHER WARRANTIES EITHER ORAL OR WRITTEN. ANY IMPLIED WARRANTIES WHICH MAY ARISE BY OPERATION OF LAW, INCLUDING THE IMPLIED WARRANTIES OF MERCHANTABILITY AND FITNESS FOR A PARTICULAR PURPOSE, ARE LIMITED TO THE ONE YEAR DURATION FROM THE DATE OF PURCHASE AS DESCRIBED ABOVE.

Some states do not allow limitations on how long an implied warranty lasts, so the above limitation may not apply to you.

## Don't forget to register your product!

Registering is quick, easy and offers you benefits over the lifetime of your product. You'll receive:

### **BISSELL Rewards Points**

Automatically earn points for discounts and free shipping on future purchases.

### **Faster Service**

Supplying your information now saves you time should you need to contact us with questions regarding your product.

### **Product Support Reminders and Alerts**

We'll contact you with any important product maintenance reminders and alerts.

### **Special Promotions**

Optional: Register your email to receive notice of offers, contests, cleaning tips and more!

**Visit [www.bissell.com/registration](http://www.bissell.com/registration) now!**

## BISSELL consumer services

For information about repairs or replacement parts, or questions about your warranty, call:

### **BISSELL Consumer Services**

**1-800-237-7691**

Monday – Friday 8 am - 10 pm ET

Saturday 9 am - 8 pm ET

Or write:

BISSELL Homecare, Inc.

PO Box 3606

Grand Rapids MI 49501

ATTN: Consumer Services

Or visit the BISSELL website - **[www.bissell.com](http://www.bissell.com)**

When contacting BISSELL, have model number of cleaner available.

Please record your Model Number: \_\_\_\_\_

Please record your Purchase Date: \_\_\_\_\_

**NOTE: Please keep your original sales receipt. It provides proof of purchase date in the event of a warranty claim. See Warranty on page 15 for details.**



©2012 BISSELL Homecare, Inc.  
Grand Rapids, Michigan  
All rights reserved. Printed in China  
Part Number 110-4382  
Rev 12/11  
Visit our website at:  
[www.bissell.com](http://www.bissell.com)



## Free Manuals Download Website

<http://myh66.com>

<http://usermanuals.us>

<http://www.somanuals.com>

<http://www.4manuals.cc>

<http://www.manual-lib.com>

<http://www.404manual.com>

<http://www.luxmanual.com>

<http://aubethermostatmanual.com>

Golf course search by state

<http://golfingnear.com>

Email search by domain

<http://emailbydomain.com>

Auto manuals search

<http://auto.somanuals.com>

TV manuals search

<http://tv.somanuals.com>