

Electronic Air Cleaner 120-60-1 Power Supply Kit

Cancels: IIK 901K-12-5

IIK 901K-12-7
7-95

Installation Instructions Part No. 322044-701

NOTE: Read the entire instruction manual before starting the installation.

→ This symbol indicates a change since the last issue.

SAFETY CONSIDERATIONS

Recognize safety information. This is the safety-alert symbol . When you see this symbol on the unit and in instructions or manuals, be alert to the potential for personal injury.

Understand the signal words DANGER, WARNING, and CAUTION. These words are used with the safety-alert symbol. DANGER identifies the most serious hazards which **will** result in severe personal injury or death. WARNING signifies a hazard which **could** result in personal injury or death. CAUTION is used to identify unsafe practices which **would** result in minor personal injury or product and property damage.

INTRODUCTION

→ This instruction covers the installation of power supply kit Part No. 322044-701 in an electronic air cleaner with a 120v-60Hz-1 phase power supply.

DESCRIPTION AND USAGE

→ The kit is designed to replace both current and previous design power supplies for duct-mounted models only. See Step 2 for models 31MB and 907A; see Step 3 for models 31MM, 31MP, 901A and B also 907B and C; see Step 4 for models 31SX, 120v 31KAX, 901E and G, 120v 901KAX; see Step 5 for 240v models 31SX, 31KAX, 901E, 901KAX, and 901G.

The kit contains the following items:

Power supply	1
Busbar assembly (2-3/16 in., 4-13/16 in., and 8-1/2 in.)	1 each
Wirenut	4
Phillips-head sheet-metal screw	4
6-32 machine screw	2
Hex nut	1
Wire clip	1
Angle bracket	1
Installation Instructions	1

INSTALLATION

Step 1—Remove Power Supply

1. Turn off main electrical supply to air cleaner and air handler.
- 2. Remove power door from air cleaner. Remove inside of door to expose the power supply.
3. Disconnect existing wires from existing power supply.
4. Remove existing power supply from power door.

CAUTION

Use care when attaching wires or bus bar to the new power supply to avoid damaging terminals and/or printed-circuit board.

Step 2—Install New Power Supply in Model 31MB or 907A

1. Cut terminal ends off wires disconnected from failed power supply and strip 1/2 in. insulation from wires.
2. Using 4 sheet-metal screws provided in kit, install new power supply.
3. Choose proper length bus bar (2-3/16 in.) and assemble angle bracket to bus bar. (See Fig. 1.)
4. Using machine screw and nut, attach existing surge resistor to angle bracket. (See Fig. 1.)
5. Attach bus bar to high-voltage terminal of power supply.
6. Using wire nuts provided in kit, splice wires. Violet wire can attach to either red wire. (See Fig. 1.)
7. Route wires so they will not contact high-voltage circuit and install wire clip.
8. Reinstall power door in air cleaner.
9. Turn on main electrical supply to the air cleaner and air handler.
10. Check air cleaner for proper operation before leaving job.

→ Step 3—Install New Power Supply in Models 31MM, 31MP, 901A and B, also 907B and C

1. Using 4 sheet-metal screws provided in kit, install new power supply.
2. Cut terminal ends off wires disconnected from failed power supply and strip 1/2 in. of insulation from wire. Splice wires to new power supply wires with wire nuts provided in kit. (See Fig. 1.)
3. Remove existing surge resistor, if applicable, and discard. Surge resistor is an integral part of the new power supply.
4. Install proper length bus bar.
5. Route wires so they will not contact high-voltage circuit and install wire clip.
6. Reinstall power door in air cleaner.
7. Turn on main electrical supply to the air cleaner and air handler.
8. Check air cleaner for proper operation before leaving the job.

→ Step 4—Install of New Power Supply in 120v Models 31KAX, 31SX, 901E and G, and 901KAX

1. Using 4 sheet-metal screws provided in kit, install new power supply.

Manufacturer reserves the right to discontinue, or change at any time, specifications or designs without notice and without incurring obligations.

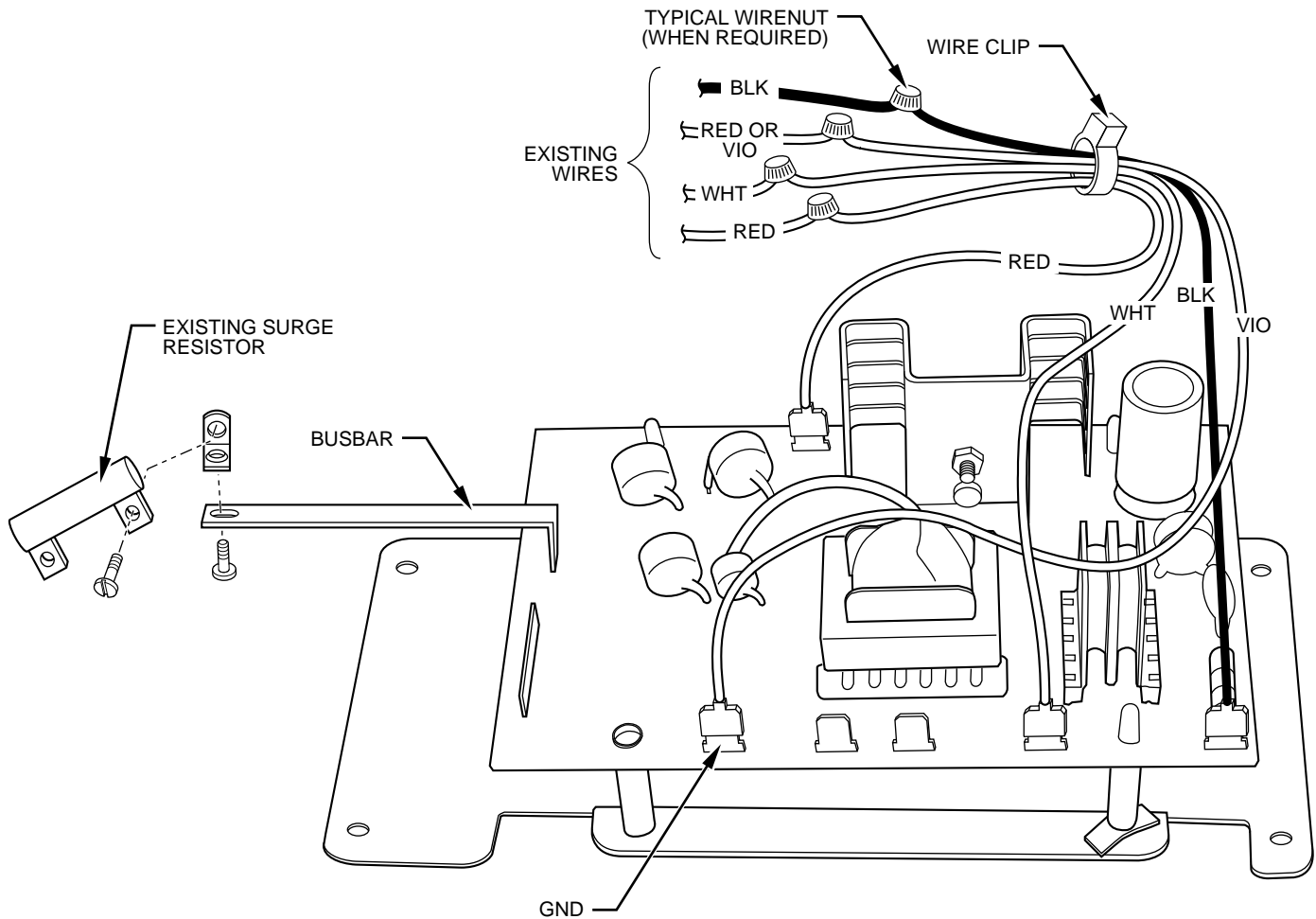

A95271

Fig. 1—Models 31MB, 31MM, 31MP, 31SX, 907A, 901A/B, 901E/G, 907B/C with 120-60-1 Electrical Supply

2. Remove wires from power supply and discard.
3. Connect existing wires and bus bar for models 31SX and 901E also G. (See Fig. 1.) Do the same for models 31KAX and 901KAX. (See Fig. 3.)
4. Reinstall power door in air cleaner.
5. Turn on main electrical supply to air cleaner and air handler.
6. Check air cleaner for proper operation before leaving job.
3. Connect existing wires and bus bar for models 31SX and 901E also G. (See Fig. 2.) Do the same for models 31KAX and 901KAX. (See Fig. 4.)
4. Reinstall power door in air cleaner.
5. Turn on main electrical supply to air cleaner and air handler.
6. Check air cleaner for proper operation before leaving job. If the unit fails to operate, check for faulty transformer.

Step 5—Install New Power Supply in 240v Models 31KAX, 31SX, 901E also G, and 901KAX

1. Using 4 sheet-metal screws provided in kit, install new power supply.
2. Remove and discard wires from power supply.

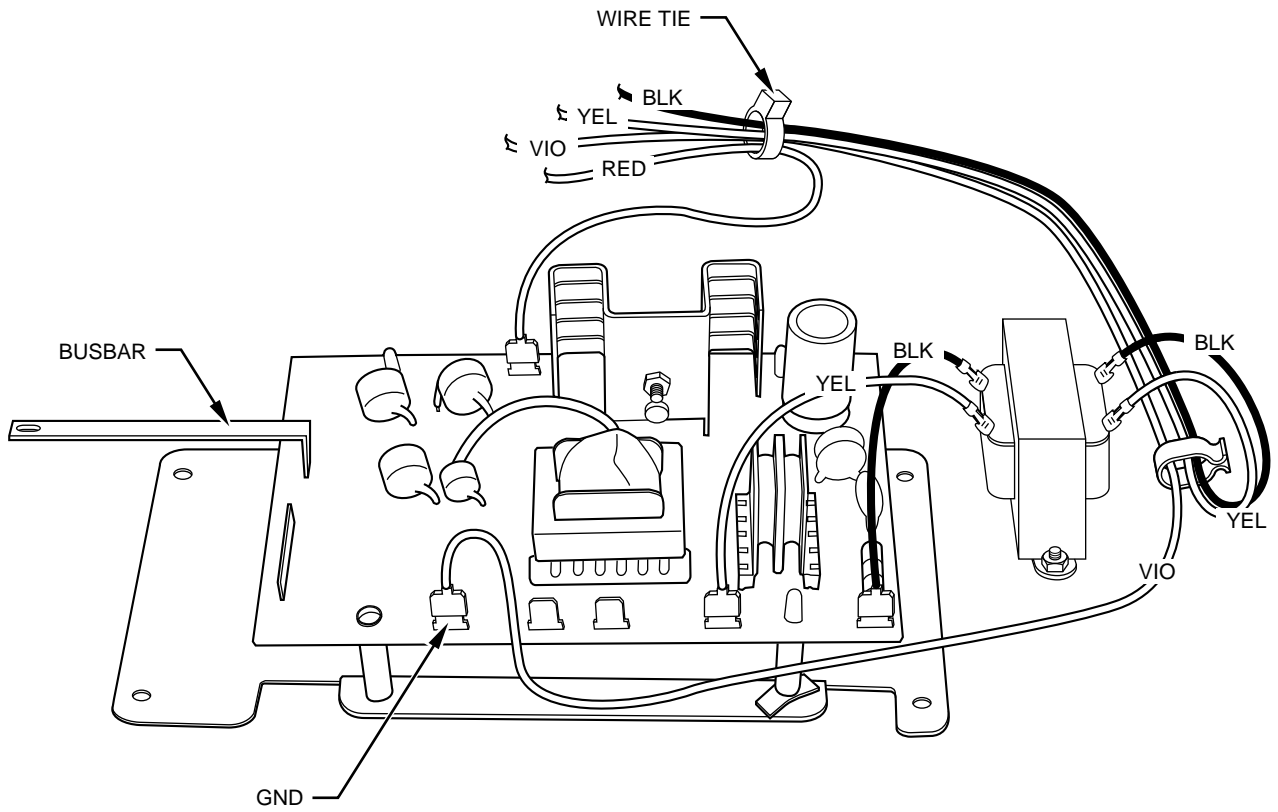

Fig. 2—Models 31SX, 901E, and 901G with 240-60-1 Electrical Supply

A95272

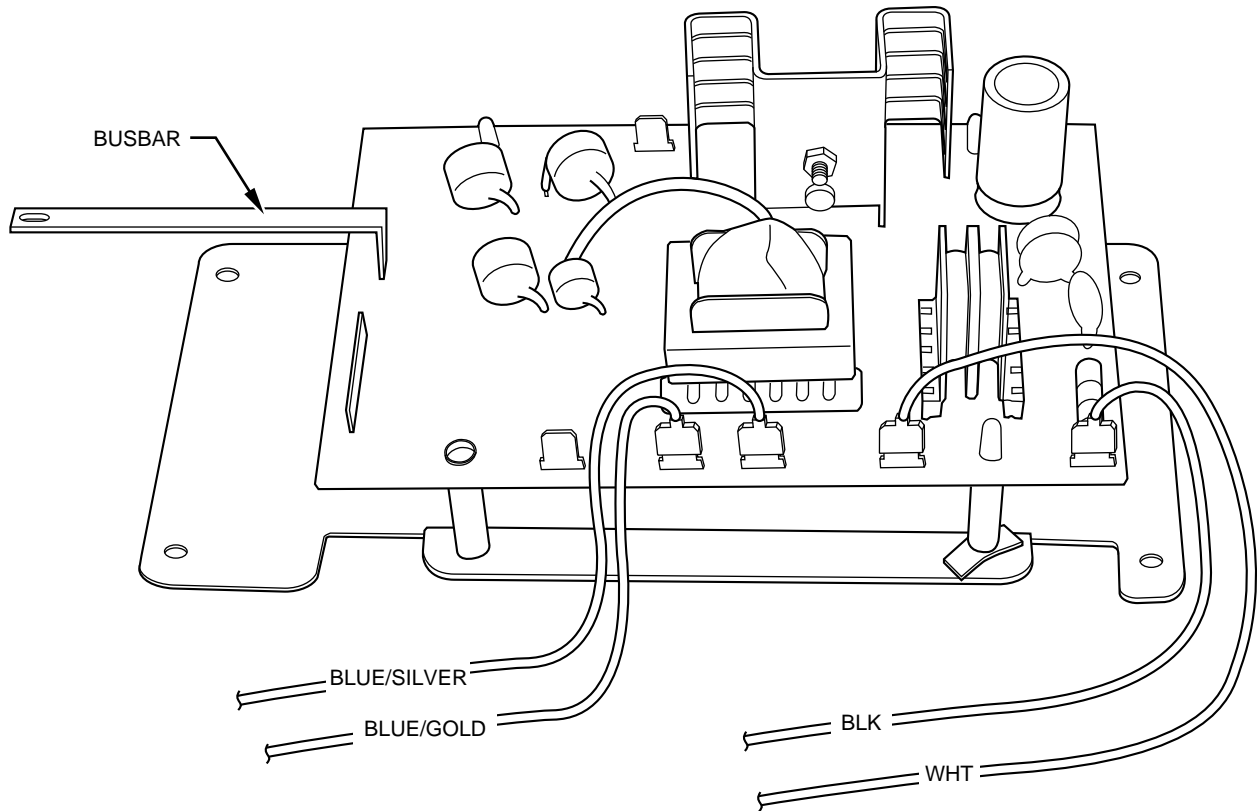

Fig. 3—Models 31KAX/901KAX with 120-60-1 Electrical Supply

A95273

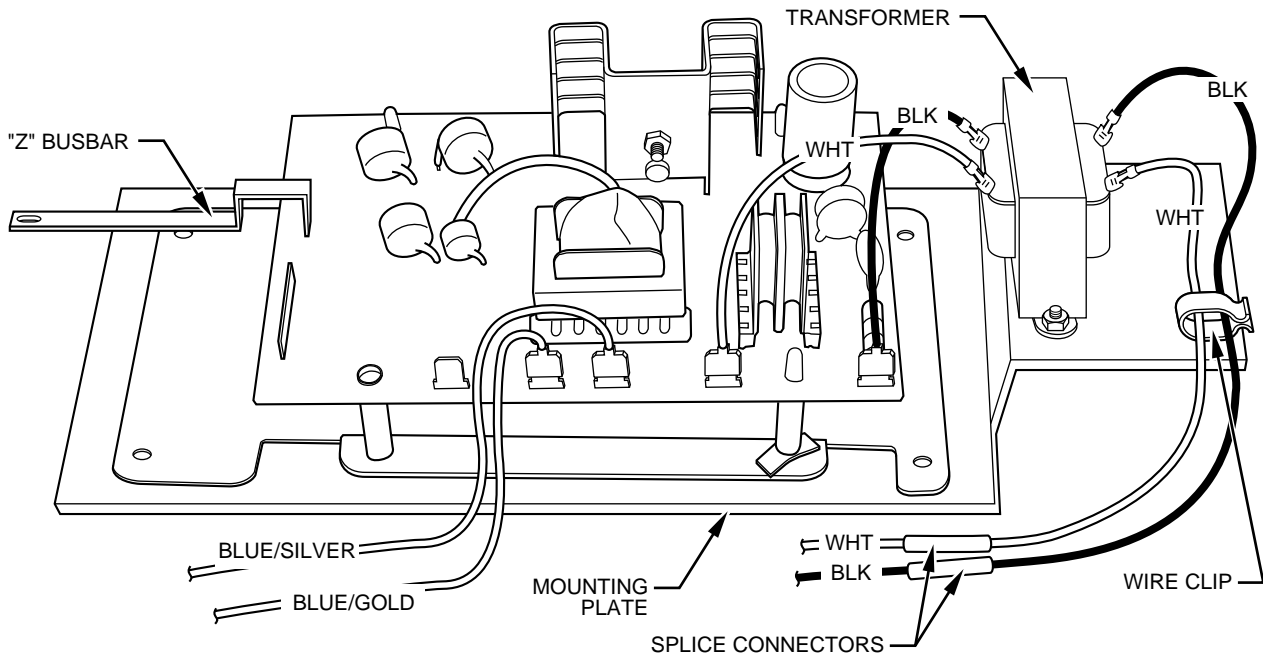

Fig. 4—Models 31KAX/901KAX with 240-60-1 Electrical Supply

Free Manuals Download Website

<http://myh66.com>

<http://usermanuals.us>

<http://www.somanuals.com>

<http://www.4manuals.cc>

<http://www.manual-lib.com>

<http://www.404manual.com>

<http://www.luxmanual.com>

<http://aubethermostatmanual.com>

Golf course search by state

<http://golfingnear.com>

Email search by domain

<http://emailbydomain.com>

Auto manuals search

<http://auto.somanuals.com>

TV manuals search

<http://tv.somanuals.com>